

This Church has a seating capacity of

at 2 metres social distance

at 1 metre social distance

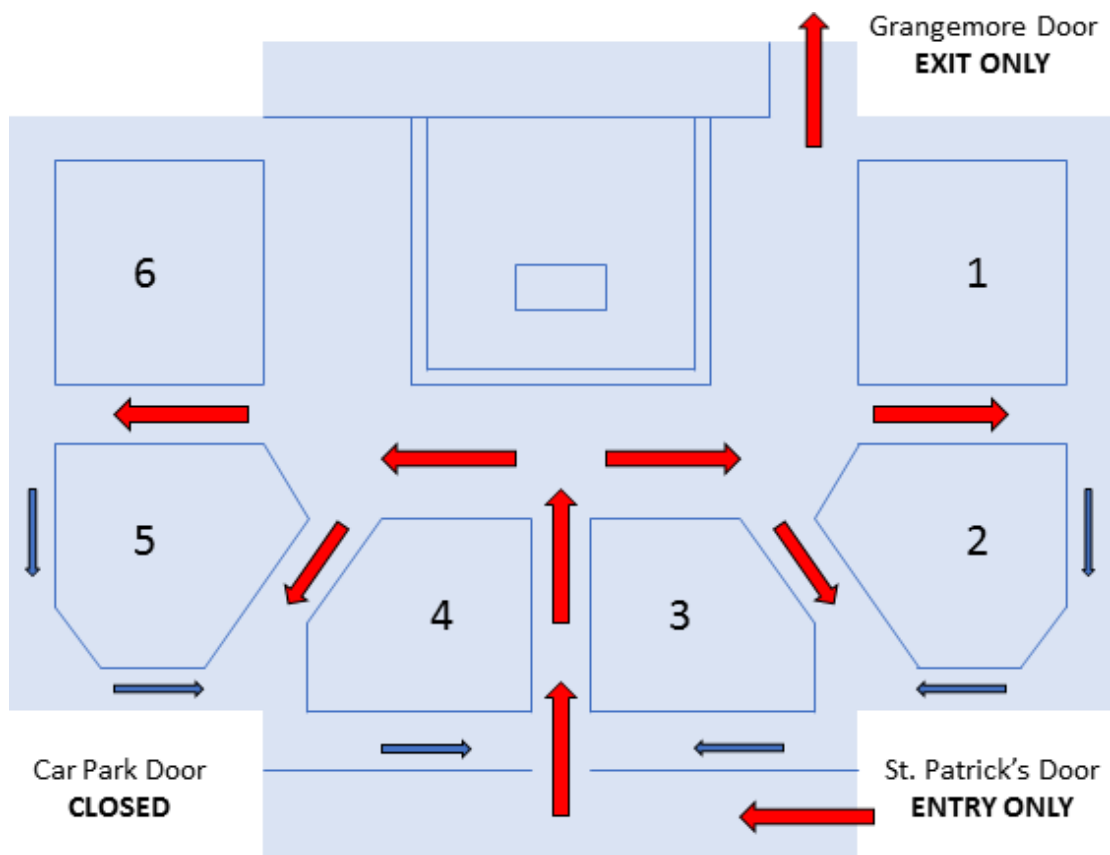

We kindly ask all our parishioners to please:-

1. Maintain social distance at ALL times.

2. Use hand sanitiser when entering the Church.

3. Wear face masks at your own personal discretion.

4. Enter the Church by the centre aisle and occupy seats one block at a time, from front row to back row within each block.

5. Sit in assigned seats marked with this symbol



It is ok for members of the same household to sit together but social distance should still be maintained with others nearby.

6. DO NOT sit in rows that have been taped off.

7. There will be a single line for communion with safe distancing symbols marked on the floor. Parishioners should proceed row by row, only joining the line when a marked spot is available, then follow the arrows to return to your seat. The Priest will be wearing a face mask & will sanitise his hands, before & after communion.



8. Collections will take place at the end of Mass at the exit doors.

9. Use the available antibacterial wipes to sanitise your seating area & dispose of it in the bins provided as you exit the Church.